

NOTES:  
 -  
 COPYRIGHT OF RICHARD SALT  
 NO IMPLIED LICENCE EXISTS

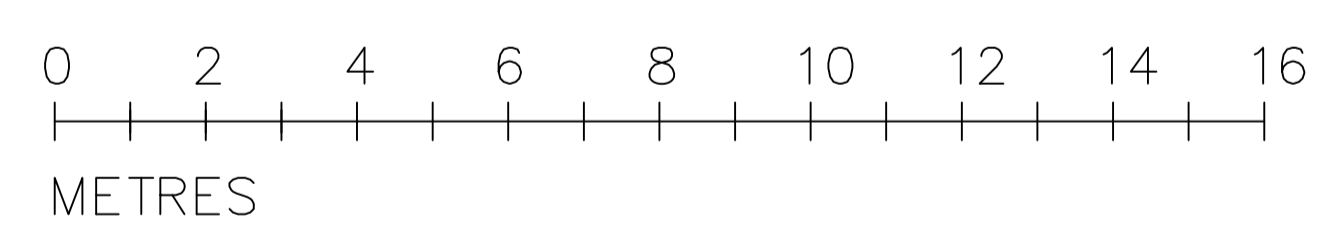

**GROUND FLOOR PLAN  
 PROPOSED**

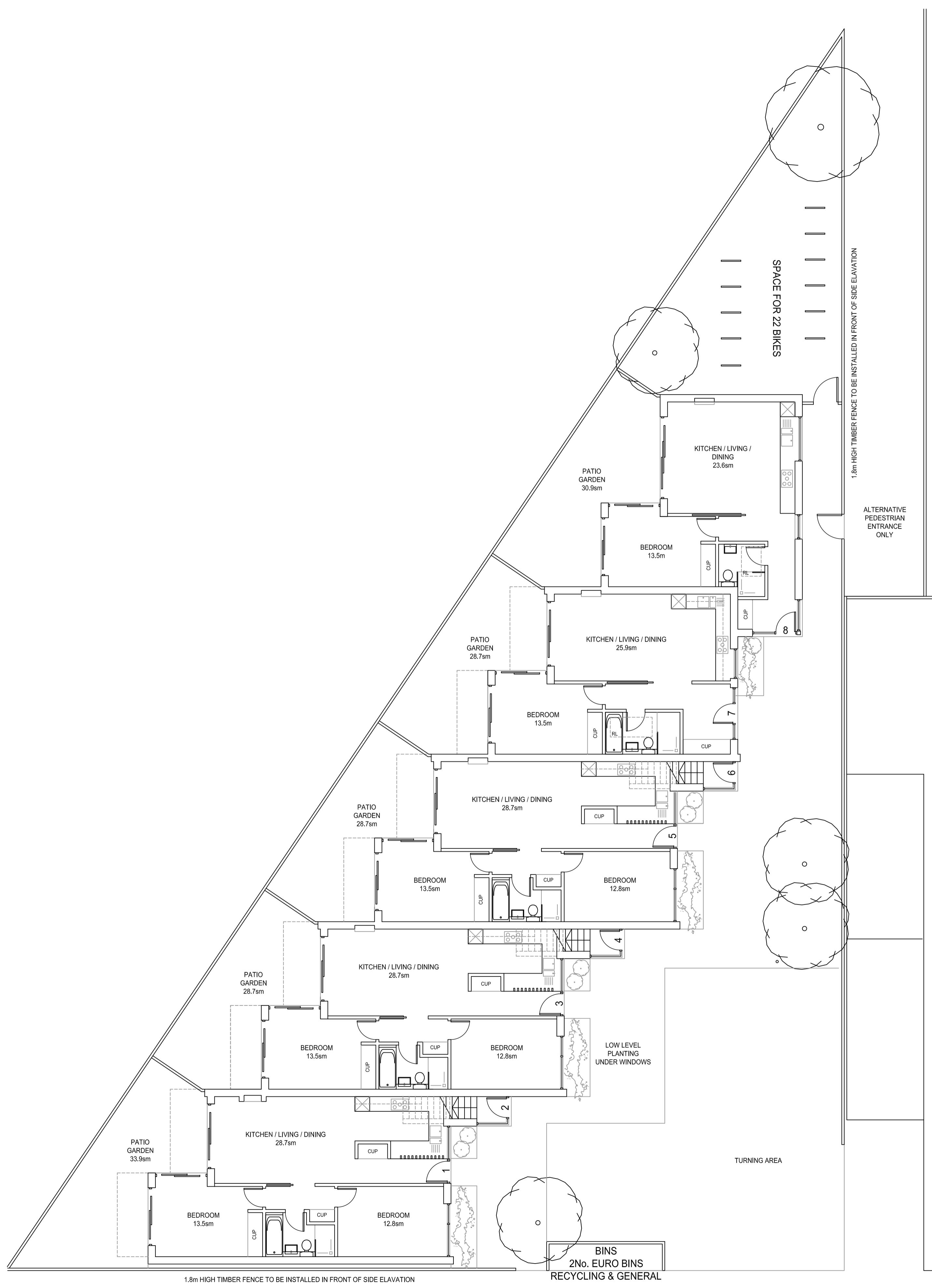
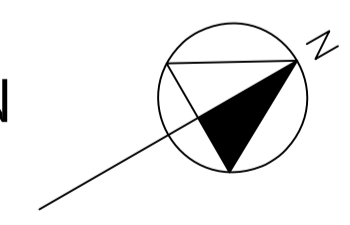

D DESIGNATED CAR PARK SPACES OMITTED	12-OCT-20		
TURNING AREA SHOWN			
C AMENDMENTS TO LAYOUT TO SUIT REDUCTION IN MASSING	06-JUL-20		
REV. DESCRIPTION:	BY: DATE:		
CLIENT: SALT WHITE LTD 19-20 GREAT SUTTON STREET LONDON EC1V 0DR			
CLIENT: WOODVILLE MEWS LTD			
PROJECT: LAND TO REAR OF 2-16 WOODVILLE ROAD LONDON, SM4			
TITLE: GROUND FLOOR PLAN PROPOSED			
SCALE: 1:100@A1	DATE: DEC-19	DRAWN: RS	CHECKED: RS
JOB NO: 0119 - P6-03	DRG NO:	REV:	D

This page is intentionally left blank